

C80 EXTERNAL FLOAT CHAMBER



www.k-dyne.com

702 South Persimmon, Suite 1C
Tomball, TX 77375
P: 281.397.7099
F: 281.397.7495

MODEL C80 EXTERNAL FLOAT CHAMBER

The C80 external cage is specifically designed for use with the K-Dyne Model L80 pneumatic and electric level switches. This unit is ideal for externally mounting of a level switch to a tank or vessel where the distance between process piping connections is at a minimum.

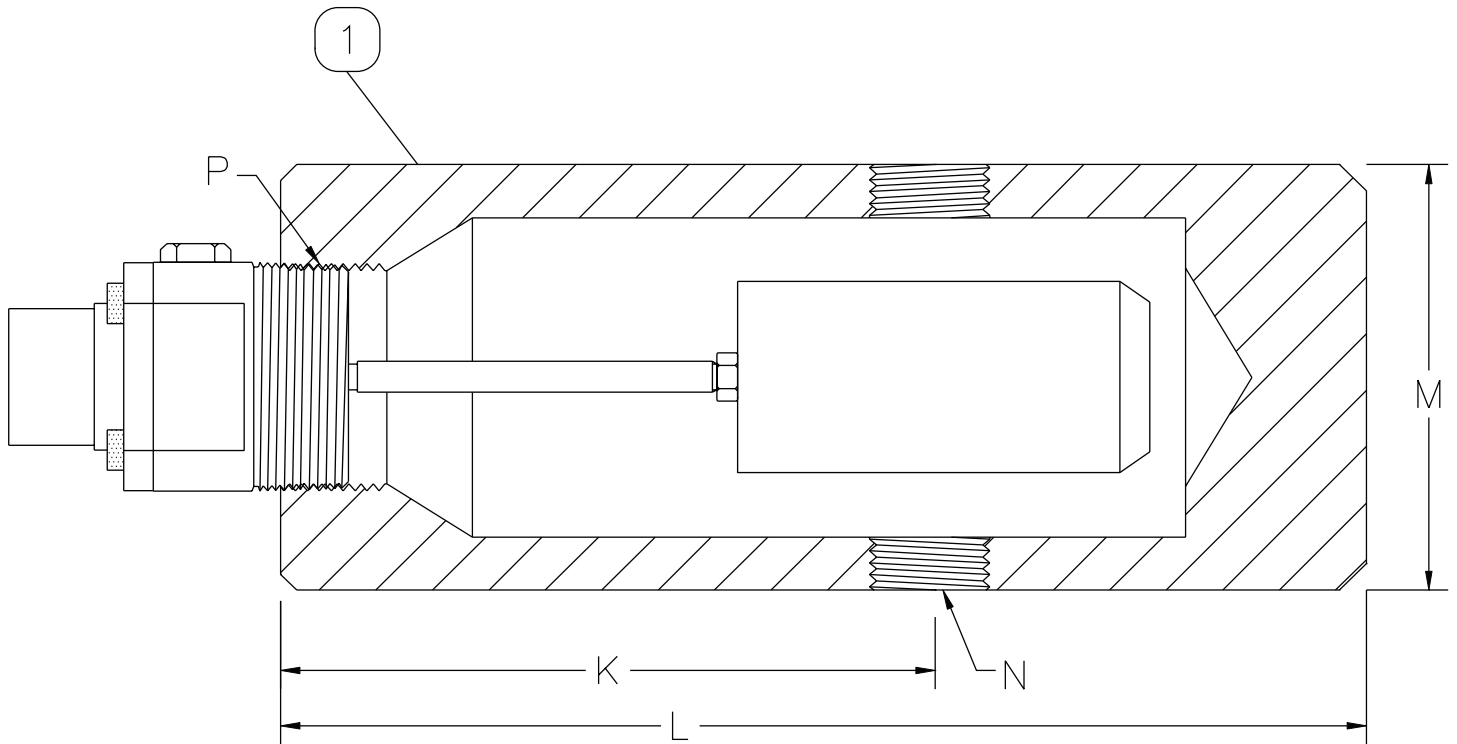

Parts List for C80

ITEM NO.	QTY.	DESCRIPTION	MATERIAL	PART NO.
1	1	Cage Body	ASTMA A-108 Gr 1018 Wrought Stl.	3C-001-000

SPECIFICATIONS

Maximum Test Pressure PSI (BAR) @ 100° F (37° C)	3240 (223)
Maximum Working Pressure PSI (BAR) @ 100° F (37° C)	2160 (149)
Operating Temperature Range	-20/+500° F -29/+260° C

DIMENSIONS in. (mm)

K	6.10 (155)
L	10.2 (259)
M	4.5 (114)
N	1" NPT (F)
P	2" NPT (F)
Weight	28 Lbs (12.7 kg)

Model Number C80

STANDARD	N.A.C.E.	HORIZONTAL	TOP/BOTTOM PROCESS PORTS	CARBON STEEL	316 ST. STEEL	NO COATING (STD)	ANSI 900	1" CONNECTION SIZE	THREADED	NO SPECIAL FEATURES
—	N	H	T0	1	3	0	9	1	T	0