

**R11 AUTO RESET RELAY**



[www.k-dyne.com](http://www.k-dyne.com)

702 South Persimmon, Suite 1C  
Tomball, TX 77375  
P: 281.397.7099  
F: 281.397.7495

# MODEL R11 AUTO RESET RELAY

The K-Dyne Model R11 pneumatic relay is a compact manually operated instrument valve that is well suited for the rigors of inland and offshore production control systems. It operates as a 3-way normally closed, automatic reset pneumatic valve with a detent (BYPASS) feature. Its construction makes it ideal for field mounting on actuators, pressure sensors or other control devices.

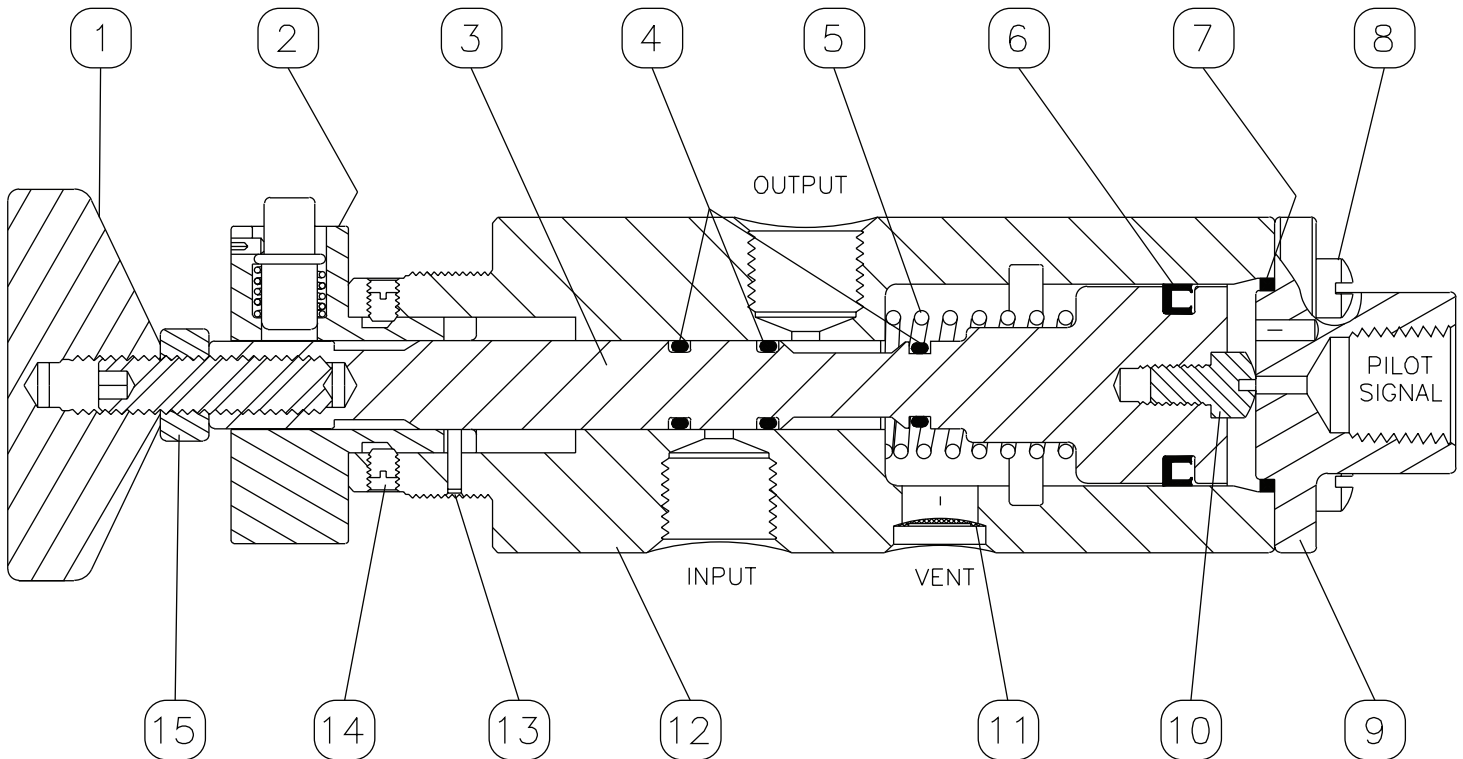

## Parts List for R11 Auto Relay

ITEM NO.	QTY.	DESCRIPTION	MATERIAL	PART NO.
1	1	Knob	Delrin 507	10-014-000
2	1	Detent Assembly	Delrin 507 (housing), AISI 316 (pin) & AISI 316 (spring)	10-017-000
3	1	Shaft Assembly	AISI 316 St. Stl. & 18-8 Set Screw	11-009-0A0
4	3	Shaft O-Ring	Flourocarbon	V0-009-75T
5	1	Spring	Inconel X-750	10-010-000
6	1	Piston Seal	Buna-N	NU-209-75T
7	1	Base O-Ring	Flourocarbon	V0-019-75H
8	4	Fillister Screw	18-8 St. Stl.	TP-832-0C4
9	1	Base	AISI 316 St. Stl.	11-002-000
10	1	End Stop	18-8 St. Stl	
11	1	Screen	AISI 304 St. Stl.	11-010-000
12	1	Body	AISI 316 St. Stl.	11-003-000
13	1	Guide Pin	AISI 302 St. Stl.	R2-002-008
14	2	Set Screw	Nylon	T4-632-045
15	1	Hex Nut	AISI 316 St. Stl.	T6-08K-073
16	---	Repair Kit	Items 4,6,7,10,11 & 14	11-011-000

## FEATURES

- Compact size saves space in panel use
- Panel mountable using optional nut
- Integral screen on "VENT" port
- Field proven materials for construction
- Will automatically open upon application of signal pressure.
- Detent pin for temporary "BYPASS"

## SPECIFICATIONS

Supply Pressure	Vacuum to 150 psi (10.3 Bar)
Pilot Signal Pressure	30 psi (2.0 Bar) to open 10 psi (.7 Bar) to close
Operating Temperature	-20/+180° F -29/+82° C
Cv Factor	.34

**Ordering Number R11-K10A2VN00**