

S16 SAND PROBE RELAY



www.k-dyne.com

702 South Persimmon, Suite 1C
Tomball, TX 77375
P: 281.397.7099
F: 281.397.7495

MODEL S16 SAND PROBE RELAY

The K-Dyne Model S16 Probe Relay is a 3-way, pilot or manually operated pneumatic/hydraulic instrument valve for use with most types of erosion/corrosion probes. This small compact valve can withstand the most rigorous environments.

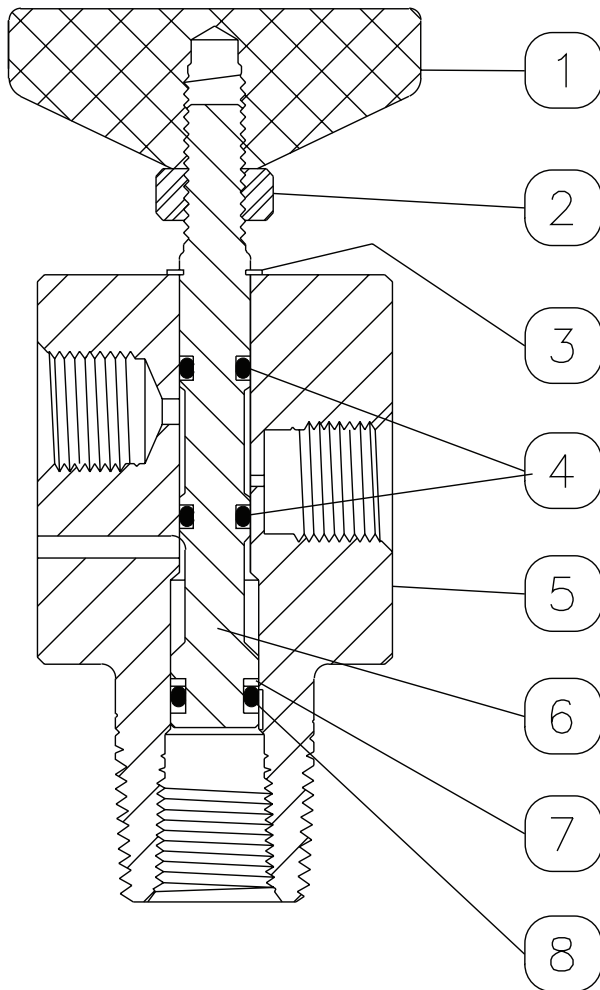

Parts List for S16 Sand Probe

ITEM NO.	QTY.	DESCRIPTION	MATERIAL	PART NO.
1	1	Knob	Delrin 507	10-014-000
2	1	Hex Nut	AISI 316 St. Stl.	T6-08K-073
3	1	Retainer Ring	AISI 302 St. Stl.	S6-B10-107
4	2	Spool O-Ring	Fluorocarbon	VQ-008-75T
5	1	Body	AISI 316 St. Stl.	16-003-000
6	1	Spool	AISI 316 St. Stl.	16-002-000
7	1	Back Up O-Ring	PTFE	TB-011-00C
8	1	O-Ring	Fluorocarbon	TP-832-0C4
9	---	Repair Kit	Items 3,4,7 & 8	16-003-000

FEATURES & BENEFITS

- Constructed of field proven materials that will provide years of trouble free service.
- May be manually operated for testing
- Not affected by vibration
- Can be mounted in any position (horizontal, vertically up or down)
- May be field or panel mounted
- 10,000 psi Probe Sense Pressure
- Meets NACE MR-01-75

SPECIFICATIONS

Maximum Instrument Pressure	150 PSI (10.3 Bar)
Maximum Probe Sense Pressure	10,000 psi (690 Bar)
Cv Factor	.085
Ambient Temperature Range	-20 to 180° F -29 to 82° C
Process Temperature Range	-20 to 300° F -29 to 149° C
Weight	1 lb. (.45 kg)

Ordering Number S16-N3BV000000